

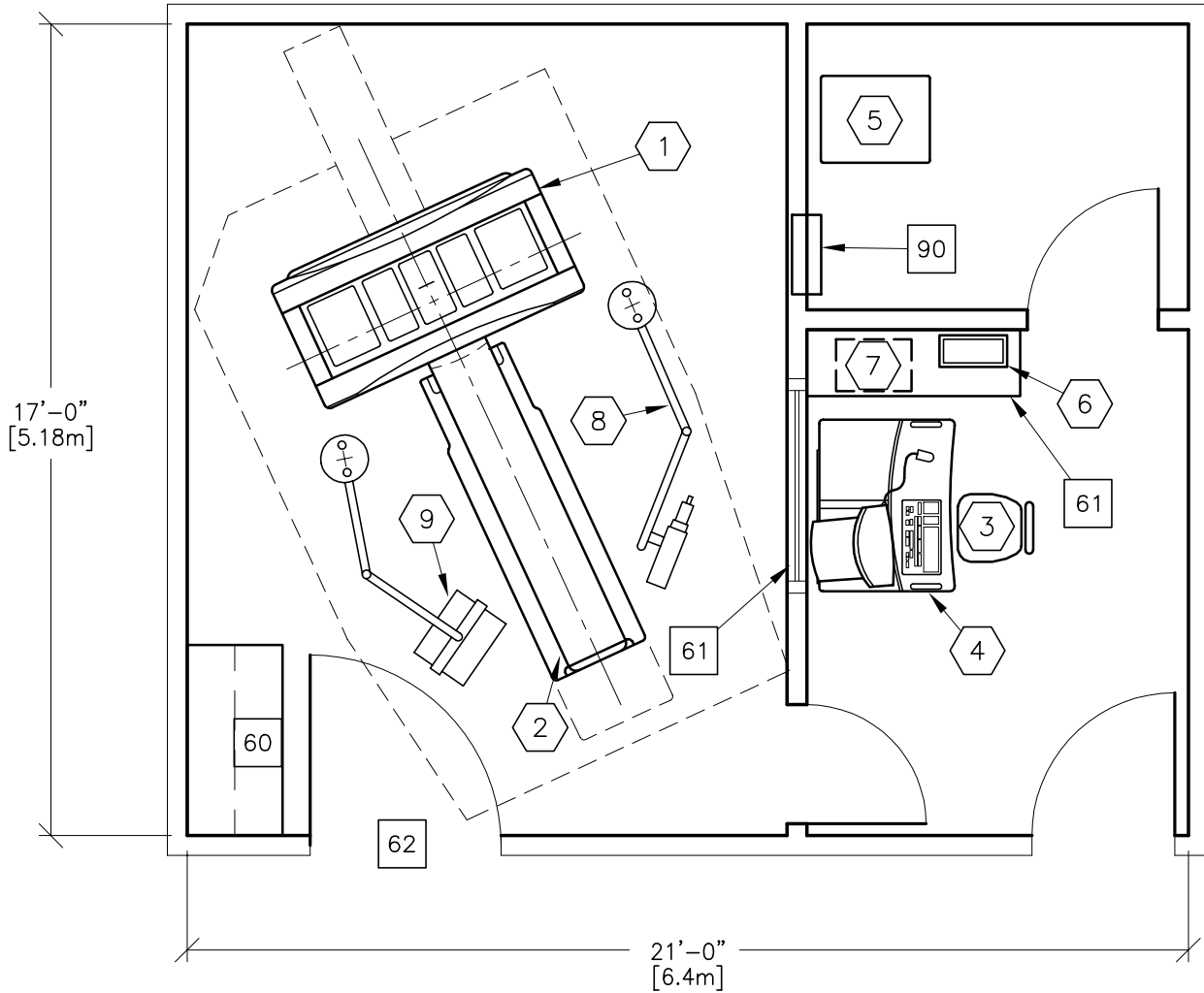

CT HISPEED LXi/FXi/DXi



RECOMMENDED CEILING HEIGHT
9'-0" [2743mm]

ROOM DIMENSIONS	LENGTH & WIDTH	CEILING HEIGHT
MINIMUM:	19'-6" x 17'-0" [5.94m x 5.18m]	8'-6" [2.59m]

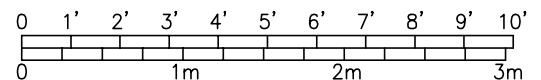

SEE APPENDIX "A" FOR POWER SPECIFICATIONS

ROOM PLAN LOCATED ON PAGE 6-28

ITEM	QUANTITY	ITEM DESCRIPTION	WEIGHT	HEAT OUTPUT
①	1	CT HiSpeed ADVANTAGE CT/I GANTRY	3750 lb 1701 kg	24403 btu 7150 W
②	1	PATIENT TABLE WITH EXTENDED TABLE TOP.	1185 lb 535 kg	700 btu 200 W
③	1	OPERATOR'S CONSOLE / COMPUTER	662 lb 300 kg	4500 btu 1320 W
④	1	POWER DISTRIBUTION UNIT	800 lb 363 kg	3400 btu 1000 W
⑤	1	OPERATOR'S CHAIR		
⑥	1	ADVANTAGE WINDOWS STATION	105 lb 48 kg	406 btu 119 W
⑦	1	REMOTE CONTROL FOR INJECTOR	4 lb 2 kg	
⑧	1	INJECTOR ELECTRONICS	37 lb 17 kg	321 btu 94 W
⑨	1	INJECTOR HEAD ON OVERHEAD COUNTERPOISED SUSPENSION	79 lb 36 kg	
⑩	1	SMARTVIEW MONITOR ON OVERHEAD COUNTERPOISED SUSPENSION	99 lb 45 kg	512 btu 150 W
<p>***** CUSTOMER/CONTRACTOR SUPPLIED AND INSTALLED ITEMS *****</p>				
⑥0		COUNTER TOP		
⑥1		LEAD GLASS WINDOW		
⑥2		MINIMUM DOOR OPENING FOR EQUIPMENT DELIVERY IS 44 IN. W X 83 IN. H [1118MM X 2108MM], CONTINGENT ON A 96 IN. [2438MM] CORRIDOR WIDTH.		
⑨0		MAIN DISCONNECT CONTROL, - WALL MOUNTED - GE CAT. NO. R4502AD, 90 LBS.		
⑨1		WORKSTATION TABLE		

ENVIRONMENT

Ambient Operation Temperature: 55-75° (F)
 Allowable Temperature Change: 15° (F) per hour
 Humidity: 20-80 percent non condensing
 Allowable Humidity Change: 10 percent per hour
 Max - Altitude: 8000 ft. above sea level